

SPECIFICATIONS

(Typical values for batteries stored at 20°C for one year)

Nominal Capacity (At 2 mA/85°C/185°F/2.0V Cut-Off)	1.7 Ah
Open Circuit Voltage (At 20°C/68°F)	3.67 V
Nominal Voltage (At 2mA/85°C/185°F)	3.6 V
Maximum Continuous Current	100 mA
Maximum Pulse Current Capability	200 mA
Rated 1 Sec. Pulse Capability (To 3V)	60 mA
Operating Temperature Range	-55 ~ 130 °C
Weight	17.0 g (0.60 oz)
Anode Surface Area	14 cm²
Volume	8.0 cm³
Diameter (Max)	14.5 mm
Height (Max)	50.5 mm

DIMENSIONS IN MM

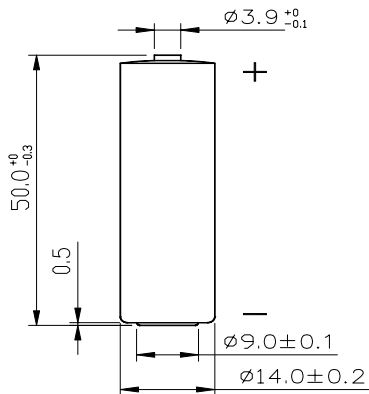

WARNING

Fire, Explosion And Severe Burn Hazard.
Do Not Recharge, Crush, Disassemble,
Heat Above 302°F(150°C), Incinerate
Or Expose Contents To Water

Voltage (V)

DISCHARGE CHARACTERISTICS AT +85 °C

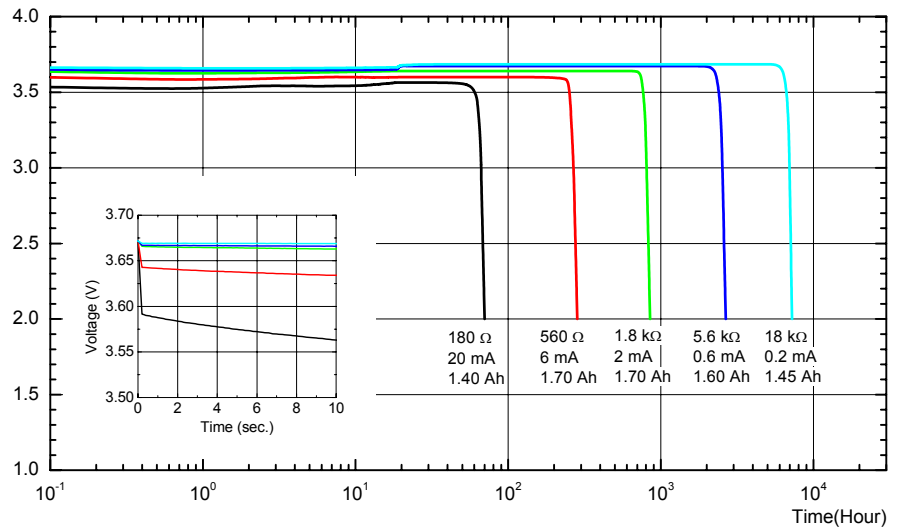

Capacity (Ah)

AVAILABLE CAPACITY

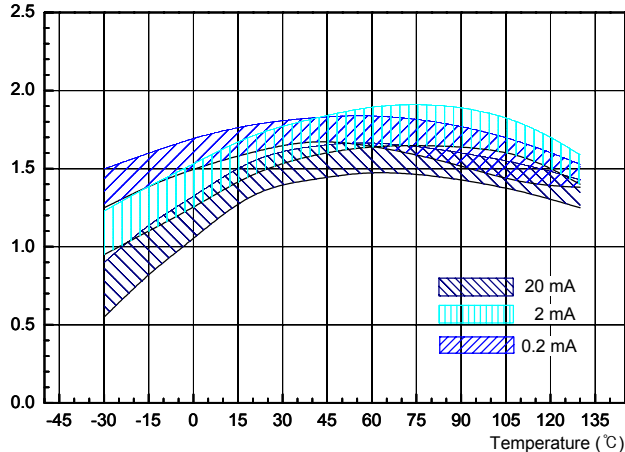

Voltage (V)

OPERATING VOLTAGE

